

theWAY

where we begin is where we shall inevitably end... MOTTON becomes

Tennis Center Southgate Design Proposal 2015 | zhuhai, china

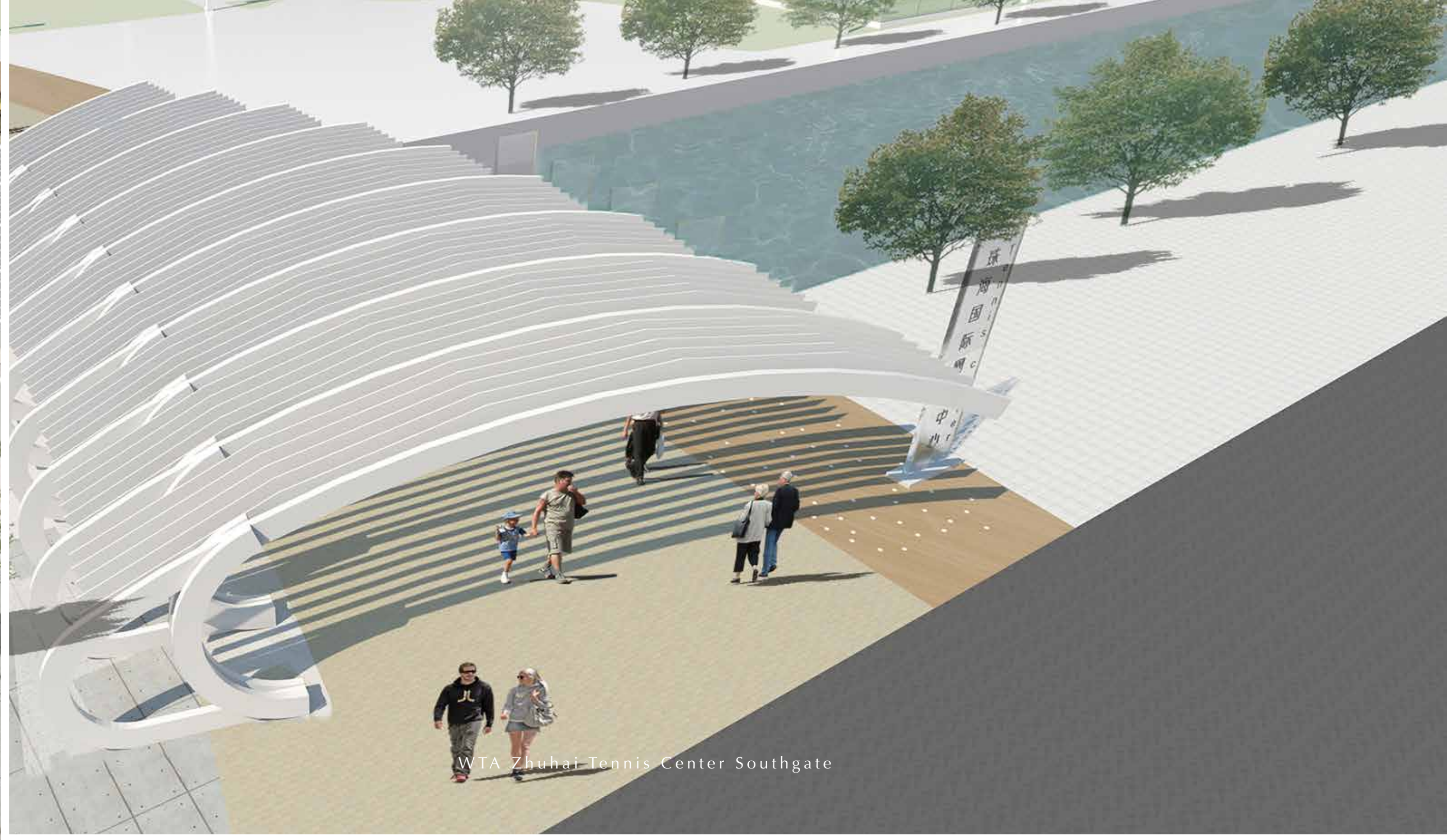

WTA Zhuhai Tennis Center Southgate

I HAVE THOUGHTS REGARDING MOTION.

SURFACEstudio...Zhuhai WTA Tennis Centre Southgate Design was a design proposal seeking to provide the new WTA development a moment to welcome all. The new south gate would become one of the primary entrances into the Zhuhai Tennis Centre. From initial thoughts about what tennis is a human activity sponsoring random un-orchestrated moments of energy to exist as if to be complex MOTIONS

It was determined that the nature of tennis resided in harmonic motions that become the WAY.

The WAY is a way of thinking (idea) about MOTION. The Way as a formed gate or entry passage became a smooth rhythmic movement around a dynamic moment or POINT (the body). The Way is a smooth gentle repetitive FORM that gradually opens in order to disperse. The form disperses slowly, rhythmic revealing the WTA Centre as a form that becomes void.

The WAY as an entry form allows entrants to pass, to sit being shelter within the form from natural elements as well as incorporating glass signage and a surface of light. The horizontal surface of light depicts the nature of tennis as a confluence of energies or forces that mark and trace the essence of time in sport across the landscape. The primary form of the WAY being a ten steel arches anchored from a single moment to span some 21 meters. A secondary series between the primary arch forms of five unanchored battens filter light tempering the intense light and heat of Zhuhai.

MOTION is a sense of FLUID that exist as PEDESTRIAN PATHS, LIGHT & EDGES that form potential moments of THE WAY...



WTA Zhuhai Tennis Center Southgate

where we begin is where we shall inevitably end... MOTION becomes

theWAY

surfaceANALYSIS | MOTION a sense of BODIES that exist as FORM, REPETITION & RHYTHM that form potential moments of the WAY...

WTA Zhuhai Tennis Center Southgate



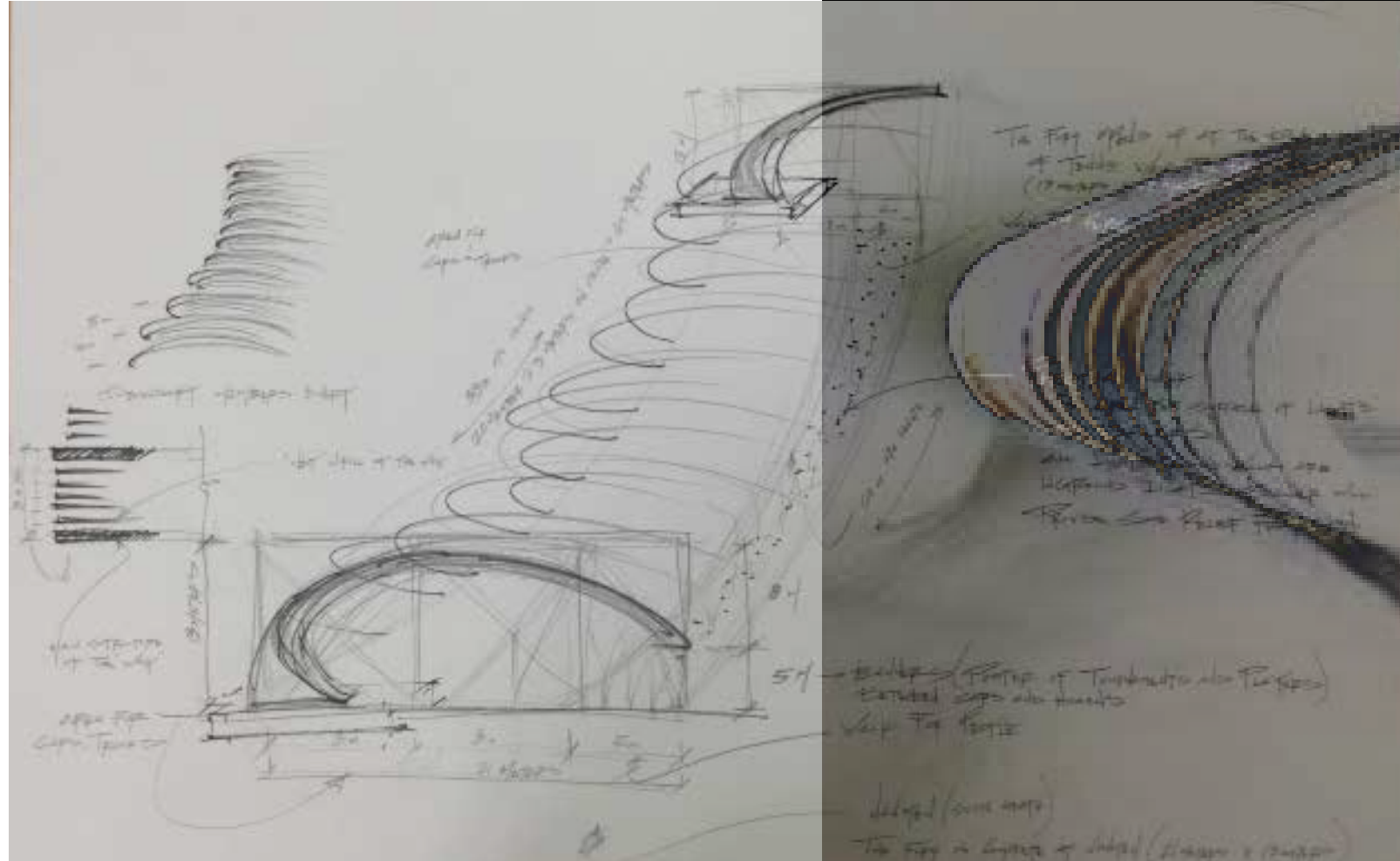

formMODEL | The form as imagined is texture and light...

WTA Zhuhai Tennis Center Southgate

surfaceAMBIANCE | Experience of the WAY as flow of light and shadow...



WTA Zhuhai Tennis Center Southgate

AMBIANCE | View of The Way from tennis center | Entry of The Way...



WTA Zhuhai Tennis Center Southgate